

## TECHNICAL DATASHEET

### ELECTRONIC CHAINSAW WITH CORDLESS LITHIUM

#### BATTERY 21,6V 4,0Ah

#### "KVS8000P"

1/4" chain and  
8" bar

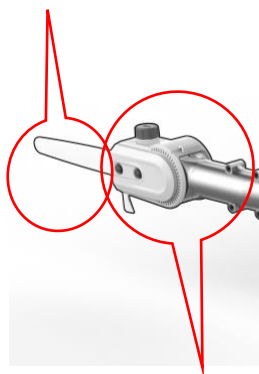

Steerable head with  
integrated oil tank and line  
for better level reading.  
Automatic and adjustable  
chain lubrication.

Display with indication  
of battery charge and  
working hours

Quick-  
connection  
rechargeable  
lithium battery  
21,6V 4,0Ah



Telescopic pole  
Length (closed) = 170 cm  
Length (open) = 250 cm

Double safety  
switch

Ergonomic handle with  
hand protection.

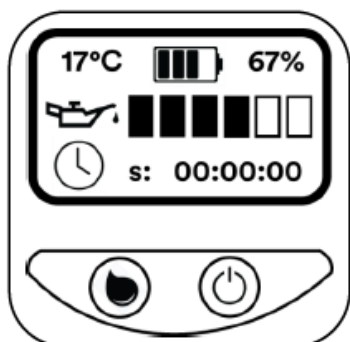
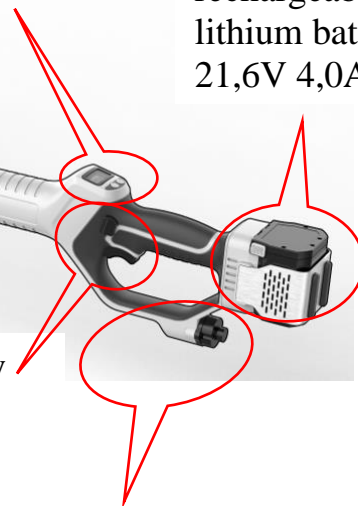

Display information:

- Electronic board temperature
- Battery charge level
- Lubrication settings
- Total and partial working time

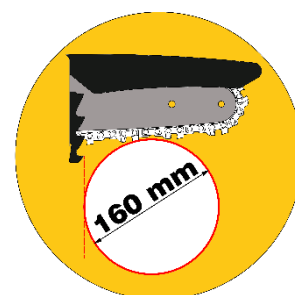



**Davide e Luigi Volpi S.p.A.**  
 **Via San Rocco, 10**  
 **46040 CASALROMANO MN –ITALIA**

**COMPANY WITH QUALITY SYSTEM**  
 **MANAGEMENT CERTIFIED BY ICIM**  
 **= ISO 9001 =**

### STANDARD EQUIPMENT

Electronic chainsaw with cordless lithium battery

Two batteries 21,6V 4,0Ah

3-way battery charger

Service Kit

### ELECTRONIC CHAINSAW WITH CORDLESS LITHIUM BATTERY 21,6 V 4,0 Ah

MAX CUTTING Ø	160 mm
BAR LENGHT	19,0 cm - 8"
CHAIN	1/4" X 1.1 48 links
CHAIN TENSION ADJUSTMENT	MANUAL
BAR LUBRICATION	AUTOMATIC AND ADJUSTABLE
GEARBOX LUBRICATION	MANUAL
DISPLAY INFORMATION	BATTERY CHARGE WORKING HOURS LUBRICATION PERCENTAGE
MOTOR	BRUSHLESS
POWER	950 W
NOMINAL TENSION	DC 21,6V
CHAINSAW DIMENSIONS	170/250 x 13 x 10 cm
WEIGHT (WITHOUT BATTERY)	4,0 Kg
WEIGHT (WITH BATTERY)	4,5 kg

### LITHIUM BATTERY 21,6 V 4,0 Ah

TENSION	21,6 V
CAPACITY	4,0 Ah
POWER	86,4 Wh
WEIGHT	0,5 Kg
BATTERY CHARGER NOMINAL TENSION	100-240 V AC 50-60 Hz
RECHARGING TIME	4 HOURS

**IMPORTANT: CAREFULLY FOLLOW THE INSTRUCTIONS TO THE USE OF THE PRODUCTS, GIVEN IN THE USER MANUALS.**